

State of the art Manufacturing Facilities



Haridwar, Noida Ph-I & Noida Ph-II Plant



Safe and Secure Connection

C&S Electric Ltd.

Corporate Office : 222, Okhla Industrial Estate, New Delhi - 110 020
Tel. : +91-11-3088 7520 - 29, Fax: +91-11-2684 7154, 2682 9063

International Business Division: Tel. : +91-11-4161 3503, 3088 7520-29, Fax: +91-11-2683 8291, 2684 7342
email : exports@cselectric.co.in

Central Marketing Office: Tel. : +91-11-3088 7520-29, Fax: +91-11-2684 8241, 2684 7342
email : cmo@cselectric.co.in, info@cselectric.co.in

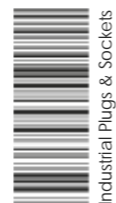

Industrial Plugs & Sockets

C&S Electric Ltd. is amongst the leading suppliers of electrical equipment in India and is India's largest exporter of industrial switchgear. It's wide range of electrical and electronic products find application in power generation, distribution, control, protection and final consumption.

In India, C&S Electric LV Components have served for over three decades in critical applications like power plants, refineries, buildings, telecom & infrastructures.

C&S LV Components touches everyone's life everyday, by protecting your homes, life & increasing your productivity at works.

C&S Plug & Sockets are designed to have main dimension applicable for Same rating, Nominal voltage, Frequency, Number poles so as to have compatibility to interchange with different make. The Plugs & Sockets ranges are:

- 3 Pin 16, 32 & 63A, 240V AC IP 44 & 67 versions
- 5 Pin 16, 32 & 63A, 415V AC IP 44 & 67 versions
- 3, 5 Pin 16 & 32A, 240/415V AC Interlocked Sockets IP 44 & 67 versions
- AC Distribution Box with Socket 16, 32 & 63A IP 40



CONTENTS

Plugs	2 ~ 7
Sockets	8 ~ 13
Connectors	14 ~ 15
Interlock Switch Socket	16 ~ 18
AC Distribution Box	19 ~ 20
Industrial Plugs & Sockets - IEC 60309 Clock	21
Application Matrix	22



Plugs

3 Pin, 5 Pin - IP44 & 67



Plugs

CS60004



- > Current: 16A
- > Voltage: 220-250V AC ~ 2P+E
- > IP44 Splash proof

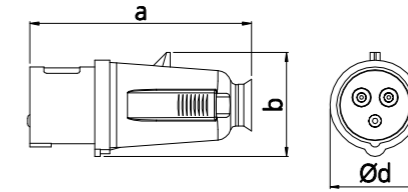

earth contact position	6h	
Pole	3	
dimension(mm)	a	125
	b	59
	d	50
cable nominal cross-section area(mm ²)	1-2.5	

CS60026



- > Current: 16A
- > Voltage: 220-250V AC ~ 2P+E
- > IP67 Watertight

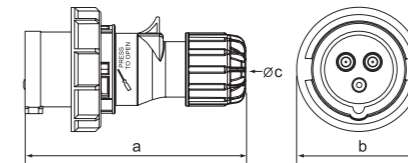

earth contact position	6h	
Pole	3	
dimension(mm)	a	120
	b	71
	c	12
cable nominal cross-section area(mm ²)	1-2.5	

CS60015



- > Current: 32A
- > Voltage: 220-250V AC ~ 2P+E
- > IP44 Splash proof

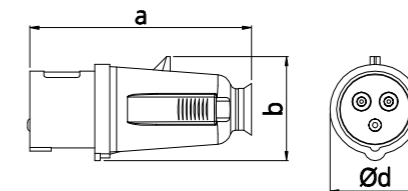

earth contact position	6h	
Pole	3	
dimension(mm)	a	155
	b	79
	d	64
cable nominal cross-section area(mm ²)	2.5-6	

CS60037



- > Current: 32A
- > Voltage: 220-250V AC ~ 2P+E
- > IP67 Watertight

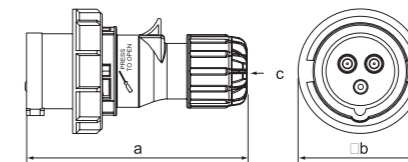

earth contact position	6h	
Pole	3	
dimension(mm)	a	150
	b	93
	c	17
cable nominal cross-section area(mm ²)	2.5-6	

CS61048



- > Current: 63A
- > Voltage: 220-250V AC ~ 2P+E
- > IP67 Watertight

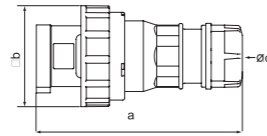

earth contact position	6h	
Pole	3	
dimension(mm)	a	250
	b	112.5
	c	30
cable nominal cross-section area(mm ²)	6-16	

CS60042



- > Current: 32A
- > Voltage: 220-380V AC ~ 3P+N+E
240-415V AC ~ 3P+N+E
- > IP67 Watertight

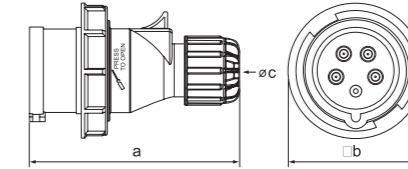

earth contact position	6h	
Pole	5	
dimension(mm)	a	155
	b	99.5
	c	17
cable nominal cross-section area(mm ²)	2.5-6	

CS60009



- > Current: 16A
- > Voltage: 220-380V AC ~ 3P+N+E
240-415V AC ~ 3P+N+E
- > IP44 Splash proof

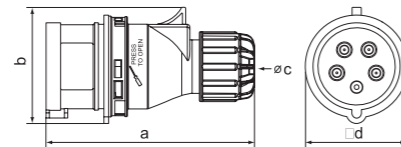

earth contact position	6h	
Pole	5	
dimension(mm)	a	133
	b	75.5
	c	12
	d	68
cable nominal cross-section area(mm ²)	1-2.5	

CS61053



- > Current: 63A
- > Voltage: 220-380V AC ~ 3P+N+E
240-415V AC ~ 3P+N+E
- > IP67 Watertight

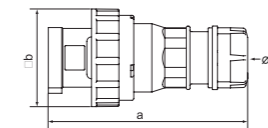

earth contact position	6h	
Pole	5	
dimension(mm)	a	250
	b	112.5
	c	30
cable nominal cross-section area(mm ²)	6-16	

CS60031



- > Current: 16A
- > Voltage: 220-380V AC ~ 3P+N+E
240-415V AC ~ 3P+N+E
- > IP67 Watertight

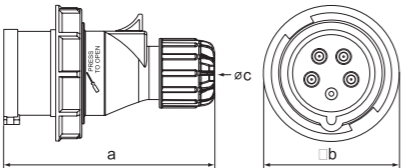

earth contact position	6h	
Pole	5	
dimension(mm)	a	133
	b	87
	c	12
cable nominal cross-section area(mm ²)	1-2.5	

CS60020



- > Current: 32A
- > Voltage: 220-380V AC ~ 3P+N+E
240-415V AC ~ 3P+N+E
- > IP44 Splash proof

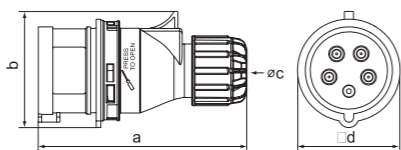

earth contact position	6h	
Pole	5	
dimension(mm)	a	155
	b	89.5
	c	17
	d	79.5
cable nominal cross-section area(mm ²)	2.5-6	

Sockets

3 Pin, 5 Pin - IP44 & 67



Sockets

CS62205



- > Current: 16A
- > Voltage: 220-250V AC ~ 2P+E
- > IP44 Splash proof

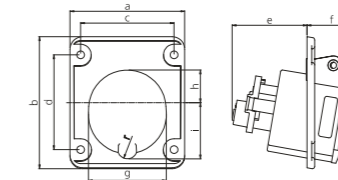

earth contact position	6h
Pole	3
dimension (mm)	a 74.5 b 85.6 c 60.3 d 61.2 e 48.5 f 32 g 50.5 h 21.5 i 36.5 r 7
cable nominal cross-section area(mm ²)	1-2.5

CS62227



- > Current: 16A
- > Voltage: 220-250V AC ~ 2P+E
- > IP67 Watertight

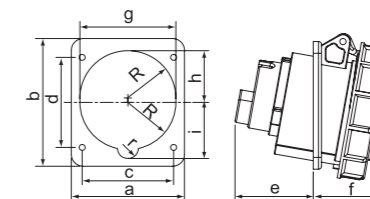

earth contact position	6h
Pole	3
dimension(mm)	a 75.5 b 86.5 c 61 d 61 e 41 f 45 g 64 h 35 i 38 R 32 r 7
cable nominal cross-section area(mm ²)	1.5-4

CS62216



- > Current: 32A
- > Voltage: 220-250V AC ~ 3P+E
- > IP44 Splash proof

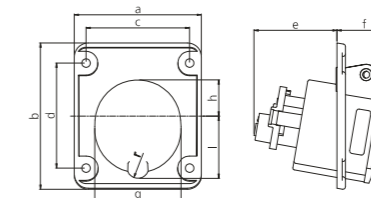

earth contact position	6h
Pole	3
dimension (mm)	a 80 b 97 c 60 d 71 e 62 f 40.5 g 65 h 37 i 41 r 10
cable nominal cross-section area(mm ²)	2.5-6







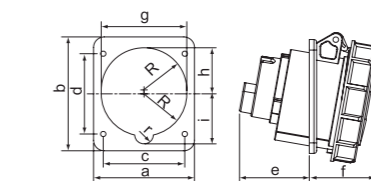

CS62238

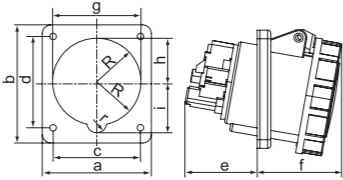

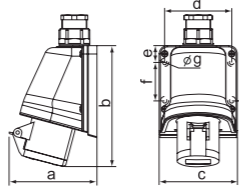

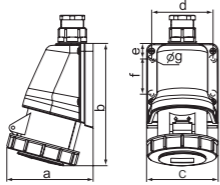

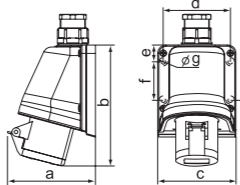

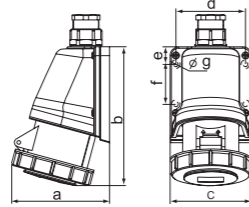
- > Current: 32A
- > Voltage: 220-250V AC ~ 2P+E
- > IP67 Watertight

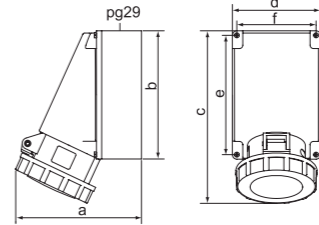

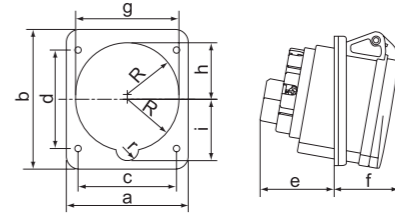
rated current(A)	6h
Pole	3
dimension(mm)	a 75.5 b 86.5 c 61 d 61 e 52.5 f 49.5 g 64 h 35 i 38 R 32 r 7
cable nominal cross-section area(mm ²)	2.5-10

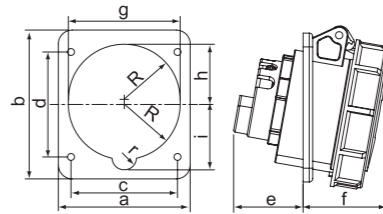
<p>CS63249</p> 	<p>> Current: 63A > Voltage: 220-250V AC ~ 2P+E > IP67 Watertight</p>	<table border="1"> <tr> <td>earth contact position</td> <td>6h</td> </tr> <tr> <td>Pole</td> <td>3</td> </tr> <tr> <td>dimension(mm)</td> <td>a 100 b 110 c 80 d 85 e 66.5 f 77.5 g 81 h 42.5 i 45.5 R 40.5 r 9</td> </tr> <tr> <td>cable nominal cross-section area(mm²)</td> <td>6-25</td> </tr> </table>	earth contact position	6h	Pole	3	dimension(mm)	a 100 b 110 c 80 d 85 e 66.5 f 77.5 g 81 h 42.5 i 45.5 R 40.5 r 9	cable nominal cross-section area(mm ²)	6-25
	earth contact position	6h								
Pole	3									
dimension(mm)	a 100 b 110 c 80 d 85 e 66.5 f 77.5 g 81 h 42.5 i 45.5 R 40.5 r 9									
cable nominal cross-section area(mm ²)	6-25									
										
<p>CS62404</p> 	<p>> Current: 16A > Voltage: 220-250V AC ~ 2P+E > IP44 Splash proof</p>	<table border="1"> <tr> <td>earth contact position</td> <td>6h</td> </tr> <tr> <td>Pole</td> <td>3</td> </tr> <tr> <td>dimension(mm)</td> <td>a 107 b 146 c 93.5 d 80 e 20 f 46 g 5.5</td> </tr> <tr> <td>cable nominal cross-section area(mm²)</td> <td>1.5-4</td> </tr> </table>	earth contact position	6h	Pole	3	dimension(mm)	a 107 b 146 c 93.5 d 80 e 20 f 46 g 5.5	cable nominal cross-section area(mm ²)	1.5-4
	earth contact position	6h								
Pole	3									
dimension(mm)	a 107 b 146 c 93.5 d 80 e 20 f 46 g 5.5									
cable nominal cross-section area(mm ²)	1.5-4									
										
<p>CS62426</p> 	<p>> current: 16A > voltage: 220-250V ~ 2P+E > IP67 watertight</p>	<table border="1"> <tr> <td>earth contact position</td> <td>6h</td> </tr> <tr> <td>Pole</td> <td>3</td> </tr> <tr> <td>dimension(mm)</td> <td>a 101 b 150 c 93.5 d 80 e 20 f 46 g 5.5</td> </tr> <tr> <td>cable nominal cross-section area(mm²)</td> <td>1.5-4</td> </tr> </table>	earth contact position	6h	Pole	3	dimension(mm)	a 101 b 150 c 93.5 d 80 e 20 f 46 g 5.5	cable nominal cross-section area(mm ²)	1.5-4
	earth contact position	6h								
Pole	3									
dimension(mm)	a 101 b 150 c 93.5 d 80 e 20 f 46 g 5.5									
cable nominal cross-section area(mm ²)	1.5-4									
										
<p>CS62415</p> 	<p>> Current: 32A > Voltage: 220-250V AC ~ 2P+E > IP44 Splash proof</p>	<table border="1"> <tr> <td>earth contact position</td> <td>6h</td> </tr> <tr> <td>Pole</td> <td>3</td> </tr> <tr> <td>dimension(mm)</td> <td>a 116 b 157 c 93.5 d 80 e 20 f 46 g 5.5</td> </tr> <tr> <td>cable nominal cross-section area(mm²)</td> <td>2.5-10</td> </tr> </table>	earth contact position	6h	Pole	3	dimension(mm)	a 116 b 157 c 93.5 d 80 e 20 f 46 g 5.5	cable nominal cross-section area(mm ²)	2.5-10
	earth contact position	6h								
Pole	3									
dimension(mm)	a 116 b 157 c 93.5 d 80 e 20 f 46 g 5.5									
cable nominal cross-section area(mm ²)	2.5-10									
										
<p>CS62437</p> 	<p>> Current: 32A > Voltage: 220-250V AC ~ 2P+E > IP67 Watertight</p>	<table border="1"> <tr> <td>earth contact position</td> <td>6h</td> </tr> <tr> <td>Pole</td> <td>3</td> </tr> <tr> <td>dimension(mm)</td> <td>a 114 b 162 c 93.5 d 80 e 20 f 46 g 5.5</td> </tr> <tr> <td>cable nominal cross-section area(mm²)</td> <td>2.5-10</td> </tr> </table>	earth contact position	6h	Pole	3	dimension(mm)	a 114 b 162 c 93.5 d 80 e 20 f 46 g 5.5	cable nominal cross-section area(mm ²)	2.5-10
	earth contact position	6h								
Pole	3									
dimension(mm)	a 114 b 162 c 93.5 d 80 e 20 f 46 g 5.5									
cable nominal cross-section area(mm ²)	2.5-10									
										

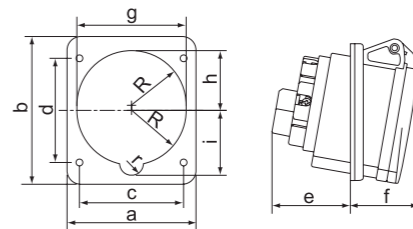
<p>CS63448</p> 	<p>> Current: 63A > Voltage: 220-250V AC ~ 2P+E > IP67 Watertight</p>	<table border="1"> <tr> <td>earth contact position</td> <td>6h</td> </tr> <tr> <td>Pole</td> <td>3</td> </tr> <tr> <td>dimension(mm)</td> <td>a 171 b 170 c 230 d 118 e 158 f 106</td> </tr> <tr> <td>cable nominal cross-section area(mm²)</td> <td>6-25</td> </tr> </table>	earth contact position	6h	Pole	3	dimension(mm)	a 171 b 170 c 230 d 118 e 158 f 106	cable nominal cross-section area(mm ²)	6-25
	earth contact position	6h								
Pole	3									
dimension(mm)	a 171 b 170 c 230 d 118 e 158 f 106									
cable nominal cross-section area(mm ²)	6-25									
										
<p>CS62210</p> 	<p>> Current: 16A > Voltage: 220-380V AC ~ 3P+N+E > 240-415V AC ~ > IP44 Splash proof</p>	<table border="1"> <tr> <td>earth contact position</td> <td>6h</td> </tr> <tr> <td>Pole</td> <td>5</td> </tr> <tr> <td>dimension(mm)</td> <td>a 75.5 b 86.5 c 61 d 61 e 40 f 41 g 64 h 35 i 38 R 32 r 7</td> </tr> <tr> <td>cable nominal cross-section area(mm²)</td> <td>1.5-4</td> </tr> </table>	earth contact position	6h	Pole	5	dimension(mm)	a 75.5 b 86.5 c 61 d 61 e 40 f 41 g 64 h 35 i 38 R 32 r 7	cable nominal cross-section area(mm ²)	1.5-4
	earth contact position	6h								
Pole	5									
dimension(mm)	a 75.5 b 86.5 c 61 d 61 e 40 f 41 g 64 h 35 i 38 R 32 r 7									
cable nominal cross-section area(mm ²)	1.5-4									
										
<p>CS62232</p> 	<p>> Current: 16A > Voltage: 220-380V AC ~ 3P+N+E > 240-415V AC ~ > IP67 Watertight</p>	<table border="1"> <tr> <td>earth contact position</td> <td>6h</td> </tr> <tr> <td>Pole</td> <td>5</td> </tr> <tr> <td>dimension(mm)</td> <td>a 75.5 b 86.5 c 61 d 61 e 40 f 48 g 64 h 35 i 38 R 32 r 7</td> </tr> <tr> <td>cable nominal cross-section area(mm²)</td> <td>1.5-4</td> </tr> </table>	earth contact position	6h	Pole	5	dimension(mm)	a 75.5 b 86.5 c 61 d 61 e 40 f 48 g 64 h 35 i 38 R 32 r 7	cable nominal cross-section area(mm ²)	1.5-4
	earth contact position	6h								
Pole	5									
dimension(mm)	a 75.5 b 86.5 c 61 d 61 e 40 f 48 g 64 h 35 i 38 R 32 r 7									
cable nominal cross-section area(mm ²)	1.5-4									
										
<p>CS62221</p> 	<p>> Current: 32A > Voltage: 220-380V AC ~ 3P+N+E > 240-415V AC ~ > IP44 Splash proof</p>	<table border="1"> <tr> <td>earth contact position</td> <td>6h</td> </tr> <tr> <td>Pole</td> <td>5</td> </tr> <tr> <td>dimension(mm)</td> <td>a 80 b 90 c 65 d 70 e 51 f 45 g 70 h 37.5 i 40.5 R 35 r 7</td> </tr> <tr> <td>cable nominal cross-section area(mm²)</td> <td>2.5-10</td> </tr> </table>	earth contact position	6h	Pole	5	dimension(mm)	a 80 b 90 c 65 d 70 e 51 f 45 g 70 h 37.5 i 40.5 R 35 r 7	cable nominal cross-section area(mm ²)	2.5-10
	earth contact position	6h								
Pole	5									
dimension(mm)	a 80 b 90 c 65 d 70 e 51 f 45 g 70 h 37.5 i 40.5 R 35 r 7									
cable nominal cross-section area(mm ²)	2.5-10									
										

CS62243



- > Current: 32A
- > Voltage: 220-380V AC ~ 3P+N+E
240-415V AC ~
- > IP67 Watertight

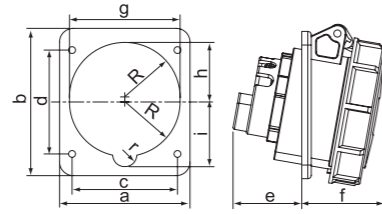

earth contact position	6h	
Pole	5	
dimension(mm)	a	80
	b	90
	c	65
	d	70
	e	51.5
	f	52.5
	g	70
	h	37.5
	i	40.5
	R	35
r	7	
cable nominal cross-section area(mm ²)	2.5-10	

CS62420



- > Current: 32A
- > Voltage: 220-380V AC ~ 3P+N+E
240-415V AC ~
- > IP44 Splash proof

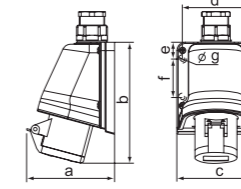

earth contact position	6h	
Pole	5	
dimension(mm)	a	119
	b	158
	c	93.5
	d	80
	e	20
	f	46
	g	5.5
cable nominal cross-section area(mm ²)	2.5-10	

CS63254



- > Current: 63A
- > Voltage: 220-380V AC ~ 3P+N+E
240-415V AC ~
- > IP67 Watertight

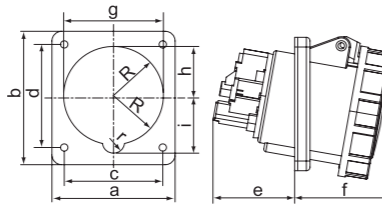

earth contact position	6h	
Pole	5	
dimension(mm)	a	100
	b	110
	c	80
	d	85
	e	66.5
	f	77.5
	g	81
	h	42.5
	i	45.5
	R	40.5
	r	9
cable nominal cross-section area(mm ²)	6-25	

CS62442



- > Current: 32A
- > Voltage: 220-380V AC ~ 3P+N+E
240-415V AC ~
- > IP67 Watertight

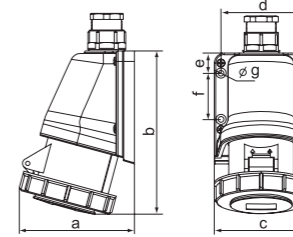

earth contact position	6h	
Pole	5	
dimension(mm)	a	116
	b	163
	c	93.5
	d	80
	e	20
	f	46
	g	5.5
cable nominal cross-section area(mm ²)	2.5-10	

CS62409



- > Current: 16A
- > Voltage: 220-380V AC ~ 3P+N+E
240-415V AC ~
- > IP44 Splash proof

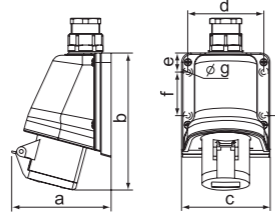

earth contact position	6h	
Pole	5	
dimension(mm)	a	114
	b	147
	c	93.5
	d	80
	e	20
	f	46
	g	5.5
cable nominal cross-section area(mm ²)	1.5-4	

CS63453



- > Current: 63A
- > Voltage: 220-380V AC ~ 3P+N+E
240-415V AC ~
- > IP67 Watertight

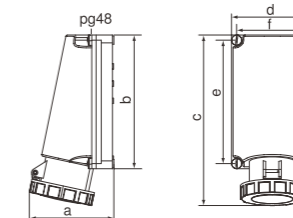

earth contact position	6h	
Pole	5	
dimension(mm)	a	171
	b	170
	c	230
	d	118
	e	158
	f	106
cable nominal cross-section area(mm ²)	6-25	

CS62431



- > Current: 16A
- > Voltage: 220-380V AC ~ 3P+N+E
240-415V AC ~
- > IP67 Watertight

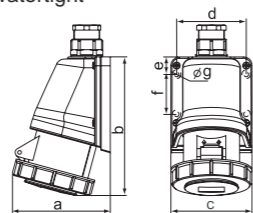

earth contact position	6h	
Pole	5	
dimension(mm)	a	107
	b	151
	c	93.5
	d	80
	e	20
	f	46
	g	5.5
cable nominal cross-section area(mm ²)	1.5-4	

Connectors

3 Pin, 5 Pin - IP44 & 67

Connectors

CS62004



- > Current: 16A
- > Voltage: 220-250V AC ~ 3P, 2P+E
- > IP44 Splash proof

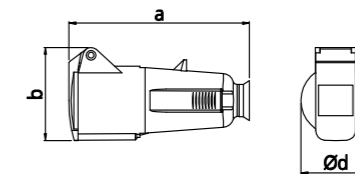

earth contact position	6h	
Pole	3	
dimension (mm)	a	131
	b	69
	d	50.5
cable nominal cross-section area(mm ²)	1-2.5	

CS62015



- > Current: 32A
- > Voltage: 220-250V AC ~ 3P, 2P+E
- > IP44 Splash proof

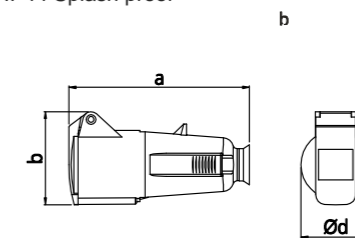

earth contact position	6h	
Pole	3	
dimension (mm)	a	165
	b	87
	d	65
cable nominal cross-section area(mm ²)	2.5-6	

CS66215



- > Current: 16A
- > Voltage: 220-380V AC ~ 3P+N+E
- > 240-415V AC ~
- > IP44 Splash proof

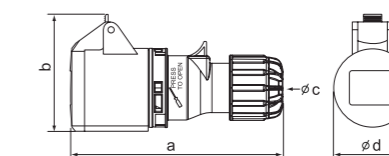

earth contact position	6h	
pole	5	
dimension(mm)	a	142
	b	89.5
	c	12
	d	62.8
cable nominal cross-section area(mm ²)	1-2.5	

CS66225



- > Current: 32A
- > Voltage: 220-380V AC ~ 3P+N+E
- > 240-415V AC ~
- > IP44 Splash proof

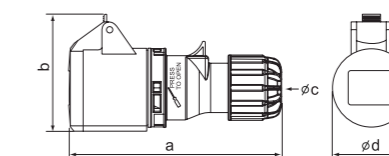

earth contact position	6h	
pole	5	
dimension(mm)	a	163.5
	b	100
	c	17
	d	71
cable nominal cross-section area(mm ²)	2.5-6	

Interlock Switch Socket

3, 5 Pin 16 & 32A, IP 44 & 67

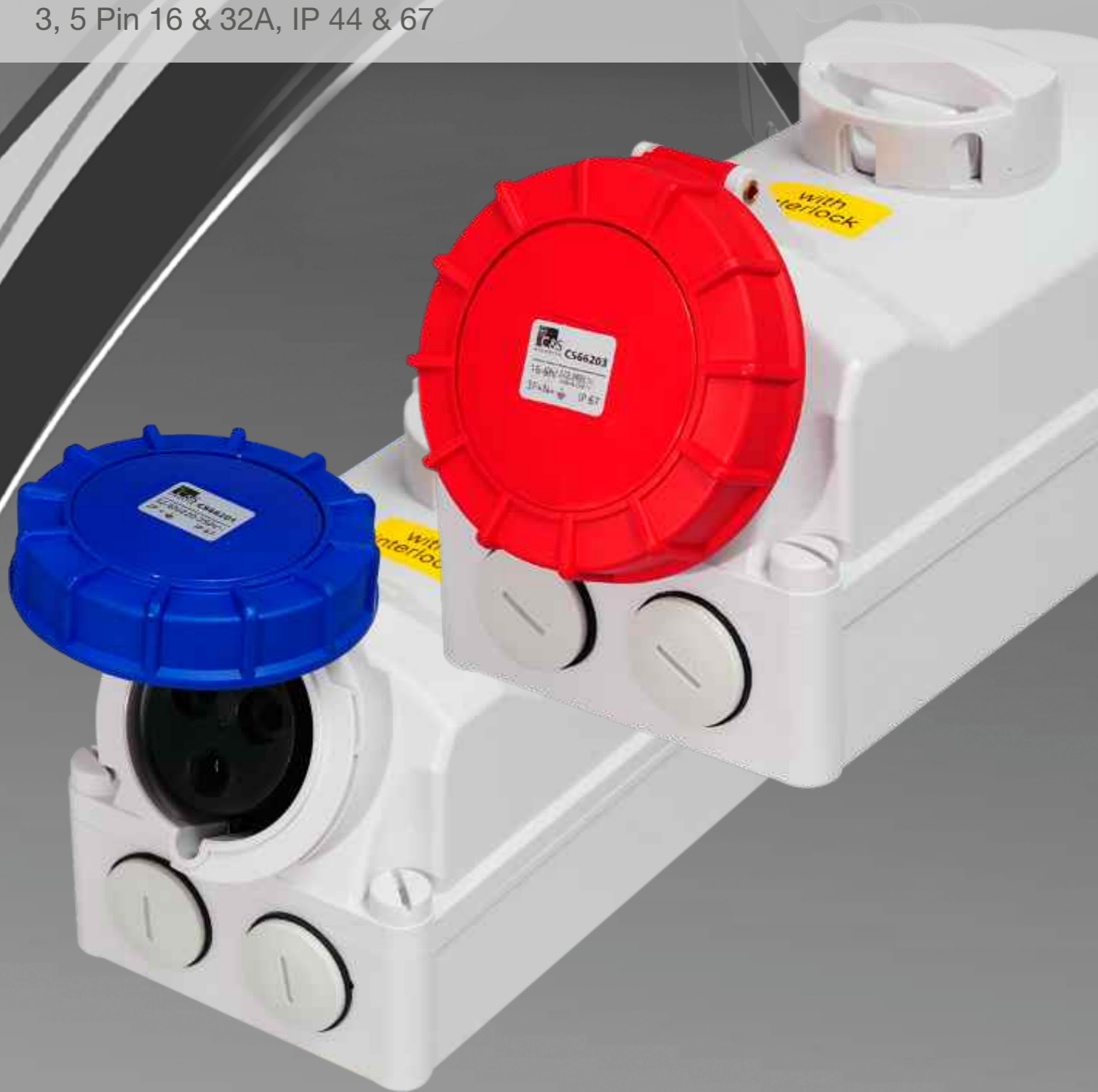

Interlock Switch Socket

CS66004(H)



- > current:16A
- > voltage:220-250V~2P+E
- > IP44
- > With switch and interlock Horizontal

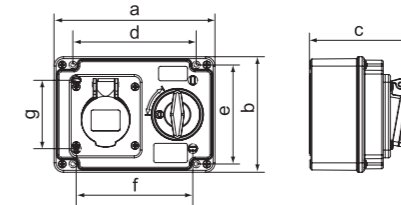

earth contact position		6h
	pole	3
dimension(mm)	a	167
	b	120
	c	108
	d	128
	e	102.8
	f	121
	g	71
cable nominal cross-section area(mm ²)		1.5-4

CS66200



- > current:16A
- > voltage:220-250V~2P+E
- > IP67 watertight
- > With switch and interlock Vertical

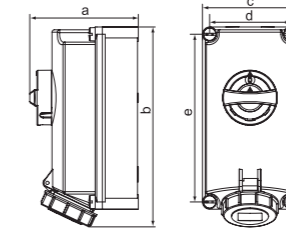

earth contact position		6h
	pole	3
dimension(mm)	a	135.8
	b	248
	c	119
	d	101
	e	208
cable nominal cross-section area(mm ²)		1.5-4

CS66015(H)



- > current:32A
- > voltage:220-250V~2P+E
- > IP44
- > With switch and interlock Horizontal

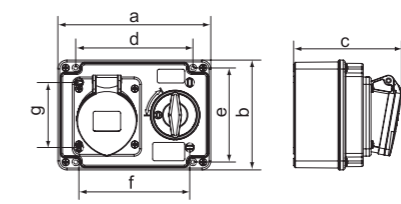

earth contact position		6h
	pole	3
dimension(mm)	a	167
	b	120
	c	118
	d	128
	e	102.8
	f	121
	g	71
cable nominal cross-section area(mm ²)		2.5-10

CS66201



- > current:32A
- > voltage:220-250V~2P+E
- > IP67 watertight
- > With switch and interlock Vertical

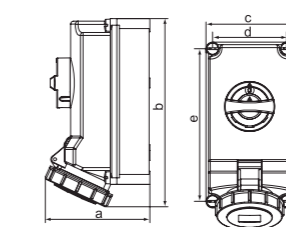

earth contact position		6h
	pole	3
dimension(mm)	a	142.5
	b	256.5
	c	119
	d	101
	e	208
cable nominal cross-section area(mm ²)		2-10

CS66109(H)



- > current: 16A
- > voltage: 220-380V~
240-415V~ 3P+N+E
- > IP44 splashproof
- > With switch and interlock - Horizontal

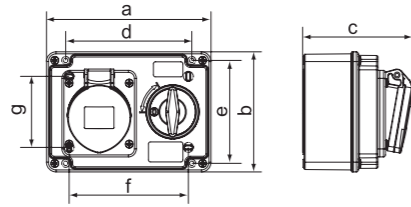

earth contact position	6h	
Pole	5	
dimension(mm)	a	167
	b	120
	c	112
	d	128
	e	102.8
	f	121
	g	71
cable nominal cross-section area(mm ²)	1.5-4	

CS66202



- > current: 16A
- > voltage: 220-380V~
240-415V~ 3P+N+E
- > IP67 watertight
- > With switch and interlock - Vertical

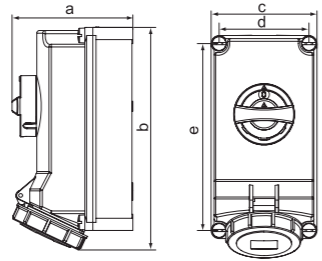

earth contact position	6h	
Pole	5	
dimension(mm)	a	135.8
	b	248
	c	119
	d	101
	e	208
cable nominal cross-section area(mm ²)	1.5-4	

CS66020(H)



- > current: 32A
- > voltage: 220-380V~
240-415V~ 3P+N+E
- > IP44 splashproof
- > With switch and interlock -Horizontal

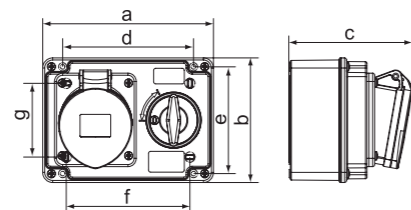

earth contact position	6h	
Pole	5	
dimension(mm)	a	167
	b	120
	c	120.5
	d	128
	e	102.8
	f	121
	g	71
cable nominal cross-section area(mm ²)	2.5-10	

CS66203



- > current: 32A
- > voltage: 220-380V~
240-415V~ 3P+N+E
- > IP67 watertight
- > With switch and interlock - Vertical

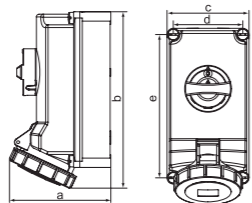

earth contact position	6h	
Pole	5	
dimension(mm)	a	147
	b	256
	c	119
	d	101
	e	208
cable nominal cross-section area(mm ²)	2.5-10	

Distribution Box with Socket

16, 32 & 63A IP 40

CS60045



Current: 16A
Voltage: 240V AC 3PIN, 2P+E
IP 40

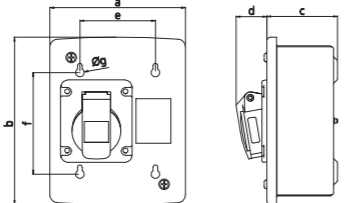

earth contact position	6h
Pole	3
dimension (mm)	a 140 b 173 c 73 d 32 e 78 f 105 g 8.8

Cs60046



Current: 32A
Voltage: 240V AC 3PIN, 2P+E
IP 40

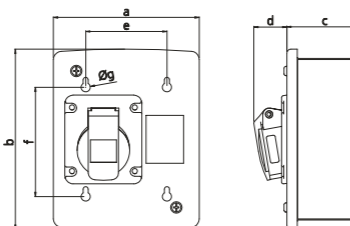

earth contact position	6h
Pole	3
dimension (mm)	a 140 b 173 c 73 d 40.5 e 78 f 105 g 8.8

CS60047



Current: 32A
Voltage: 415V AC 5PIN, 3P+N+E
IP 40

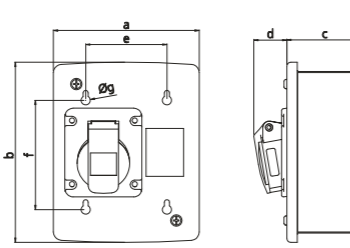

earth contact position	6h
Pole	5
dimension (mm)	a 226 b 178 c 94 d 45 e 164 f 110 g 8.8

CS60048



Current: 63A
Voltage: 415V AC 5PIN, 3P+N+E
IP 40

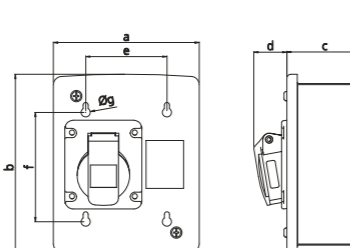

earth contact position	6h
Pole	5
dimension (mm)	a 226 b 178 c 94 d 77.5 e 164 f 110 g 8.8

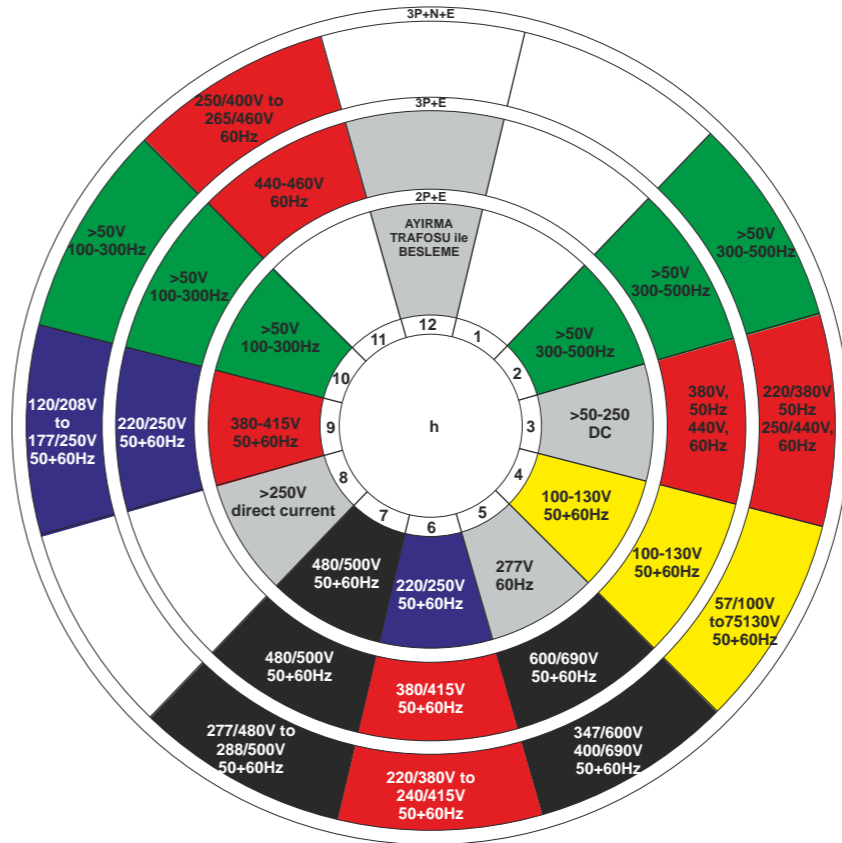

Position of the Earthing Contact

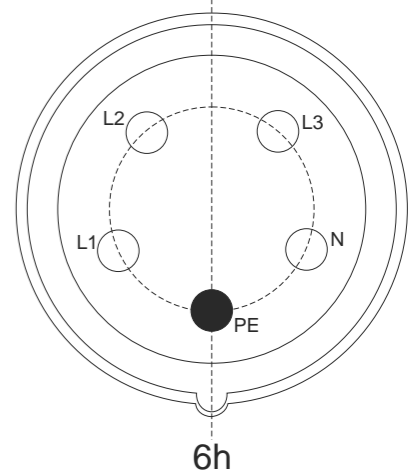

COLOUR CODES

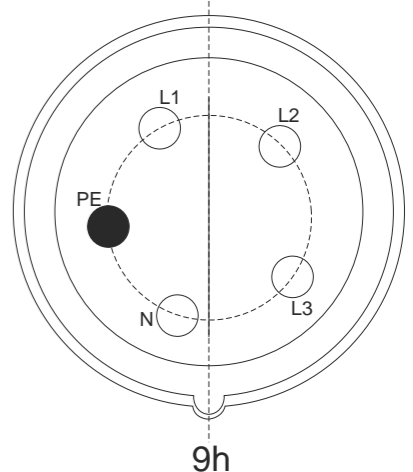

Rated Operating Voltage	Colour Code
20-25 V	violet
45-50 V	white
100-130 V	yellow
200-250 V	blue
380-480 V	red
500-690 V	black
>60-500 Hz	green
no colour code	grey

Enclosure protection

- IP 44: P&S protected against the splashing of water, the sockets are provided with a spring lid.
- IP 67: P&S protected against effects of immersion, fitted with a locking ring and bayonet coupling.

Testing of IP category

- Sockets, with lids closed or plug fully inserted
- Plugs, when fully inserted into the sockets

Benefits

- Safety through interchangeability
- High grade thermo plastic material assures:
 - Exceptional high impact resistance
 - High thermal stability
 - High insulated Quality
 - Good resistance to various chemicals
- Colour codes for easy identification of Plug & Sockets
- Locking device prevent unintended withdrawl



Sector	Environment	Typical System	Socket nominal currents (A)	Recommended installation
Commercial	Data Processing Centres	Connection of "big" processors with $1n > 3.5 \text{ mA}$	16	Flush-mounting IP 44
	Public entertainment premises	Stage light connection	16 - 32	
Industrial	Maintenance departments	Movable and portable user connection	16 - 32	Surface-mounting IP 67 on Q-DIN IP 55
	Production departments	Machine tool and process machine connection	63 - 125	Surface-mounting IP 67
	Chemical industry			
Building	Construction and demolition sites	Distribution boards	16 - 32 - 63	On Q-BOX ASC
		Socket-outlet boards	16 - 32	On Q-DIN ASC
Agriculture	Greenhouses	Movable sprayers and pumps	16	Surface-mounting IP 67 on Q-DIN IP 55
	Sheds	Movable and portable user connection	16 - 32 - 63	
Tourism	Campsites	Power outlet in service are	16 - 32	On terminal 68 Q-MC Range
	Tourist harbours		16 - 125	
Domestic	Indoor	Air Conditioner Refrigeration	16 - 32	On terminal 68 Q DIN & Metal enclosures
	Outdoor	Generator, Lawnmower Garden Lighting		

Terminal Clamping Capacity

Socket or Plug nominal current	Flexible Cables		Rigid or Stranded		Possibility of clamping several wire in the same terminal
	Minimum	Maximum	Minimum	Maximum	
16A	1	2.5	1.5	4	Up to 2 flexible cables with total section not exceeding the clamping capacity
32A	2.5	6	2.5	10	
63A	6	16	6	25	
125A	16	50	25	70	